



OPERATION MANUAL FOR HANDI-LIFT 9

Original Version

Table of contents

1	Introduction	3
1.1	Congratulations with your new CAMA Handi-Lift	3
1.2	Sketch of Handi-lift EA9	3
1.3	Generally, about the lift	4
1.4	Before you use the Handi-lift	5
2	Operation of Handi-Lift EA9	7
2.1	Operation from the lifts control panel.....	7
2.1.1	Emergency stop	7
2.1.2	Joystick	7
2.1.3	Connection for remote control with spiral wire.....	7
2.1.4	Emergency call.....	8
2.1.5	Light diode	8
2.1.6	Key lock	8
2.2	Operation from control box on wall or column	8
2.2.1	Up	9
2.2.2	Down	9
2.2.3	Open.....	9
2.2.4	Close:	9
2.2.5	Key lock	10
2.2.6	Light diode	10
2.3	Remote control with spiral wire:.....	10
2.3.1	Up	10
2.3.2	Down	11
2.4	Operation with wireless remote control:	11
2.4.1	Up	11
2.4.2	Down	11
2.4.3	Open.....	12
2.4.4	Close	12
3	Emergency lowering	12
3.1	Emergency raise of the barrier arms.....	12
3.2	Emergency raise of the platform	13
3.3	Emergency lowering of the lift	13
4	Extra equipment	13
4.1	Side access ramp	13
4.2	Fold down seat	13
4.3	Alarm/emergency call	14
4.4	Flashlight	14
4.5	Rain cover.....	14
5	What to do if your lift fails to operate	14
6	Warnings	15
7	Service	16
8	Cleaning	16

1 Introduction

1.1 Congratulations with your new CAMA Handi-Lift

Thank you for choosing a CAMA Handi-Lift. Please read the instructions carefully before using the lift.

Your CAMA Handi-Lift has been built with careful attention to detail. To obtain many years of trouble-free use, please follow the instructions with special attention to the care and maintenance requirements. We recommend that you do not undertake maintenance tasks other than routine care and cleaning explained in this handbook.

1.2 Sketch of Handi-lift EA9

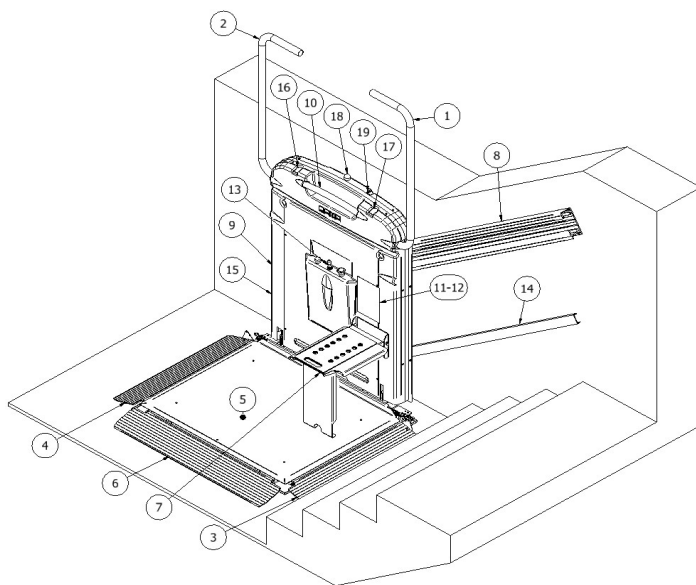

- 1) Upper barrier arm
- 2) Lower barrier arm
- 3) Upper flap
- 4) Lower flap
- 5) Platform
- 6) *Side access ramp
- 7) *Fold down seat
- 8) Rail
- 9) Cover
- 10) Handle
- 11) Nameplate
- 12) Maximum load
- 13) Operation panel
- 14) Support rail
- 15) Emergency lowering of platform
- 16) Emergency raise of lower barrier arm
- 17) Emergency raise of upper barrier arm
- 18) *Flashlight
- 19) Emergency lowering

* Extra equipment (not standard on all lifts).

1.3 Generally, about the lift

Type EA9 is a fully automatic lift, where the user does not have to operate anything manually, all operations are electrically controlled.

The Handi-Lift consists of a rail in aluminium and a lift carriage with foldable platform. The lift is equipped with barrier arms and flaps on the front and back of the platform. When touching the flaps, the plate under the platform or the safety plate under the lift carriage the lift will stop automatically to prevent jamming danger.

The Handi-Lift is designed for a wheelchair-user or a seated person (this demands a fold down seat). We cannot recommend standing up on the lift. The lift can either be operated by the user or a helper (the helper may not be on the lift together with the user). The lift is designed for straight stairs and is manufactured individually with consideration to the stair and its width. The lift can be delivered for both indoor and outdoor use.

The Handi-lift may not be used by severely handicapped persons without a helper, children as well as people influenced by medicine, alcohol or other drugs.

It may not be used to transport construction material, furniture, animal, foodstuff, cleaning equipment, chemicals, kitchen hardware and similar unless the lift is made for these purposes.

The lift may never be used for burdens that exceed the lifts weight limit. Please note that the lift is equipped with a load cell, which means that if the lift is used with too much load (overload), then the barrier arms will stop. The control lamp will flash, and the lift will emit an acoustic signal. (See the passage "What to do if your lift fails to operate").

The Handi-lifts lifting capacity is as standard 225 kg but can be delivered with a 300 kg capacity (see the lifts nameplate). Please note that when the lift is parked you must be able to open main doors and emergency exits.

In case of fire do not use the lift.

At the lift installation a main power switch is installed, where the power to the lift can be cut off. The main power switch is only used during lift maintenance. There must be light (min. 50 lux), where the lift is used,

and when maintenance of the lift is made. Furthermore, a socket has to be available near the lift installation.

1.4 Before you use the Handi-lift

The lift is equipped with various safety features, which **must** be tested before you use the lift. If the safety features do not work, you **cannot** use the lift and you shall contact your service provider.

Please note that you shall drive on the lift with the front downward. Remember to brake the wheelchair.

As user of the lift, you need to note if the functions described below works as they should, however it is the installer's task to check the functions during the installation and during the regular maintenance inspections on the lift.

Check that upper and lower barrier arm (*pos. 1 and 2 on the sketch in section 1.2*) moves as they shall. Lower barrier arm may not open at landings, as it shall prevent the user from driving off the lift in that direction.

Check upper and lower flap on the platform (*pos. 3, 4 and 5 on the sketch in section 1.2*). Touching the upper flap while the lift is driving up and the lower flap while the lift is driving down checks the flaps on the platform. The lift shall stop automatically when the flaps are touched, and it cannot drive again until the obstacle is removed. Touching the platforms under plate when the lift is driving down the stairs shall also stop the lift automatically and first when the obstacle is removed can the lift drive again.

Sketch of all the positions

The sketch below shows the Handi-lift in the various positions it can be in.

The sketches show a left-hand lift:

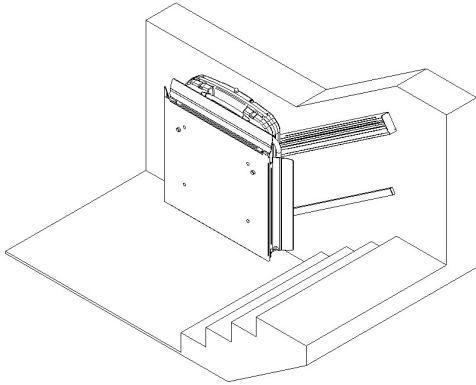

Handi-lift in parked position

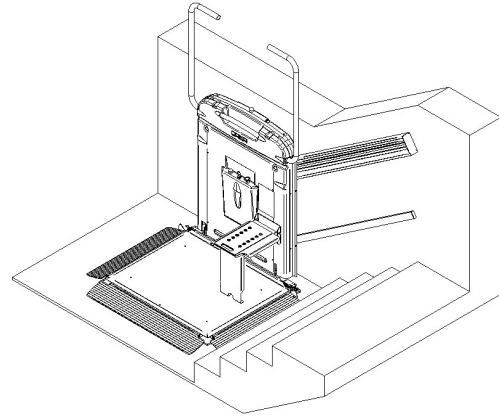

Handi-lift ready for use at the bottom of the stair

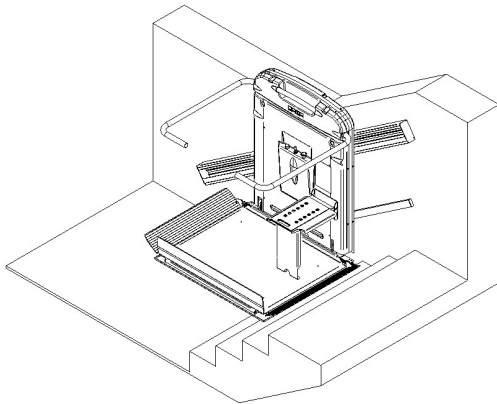

Handi-lift when driving

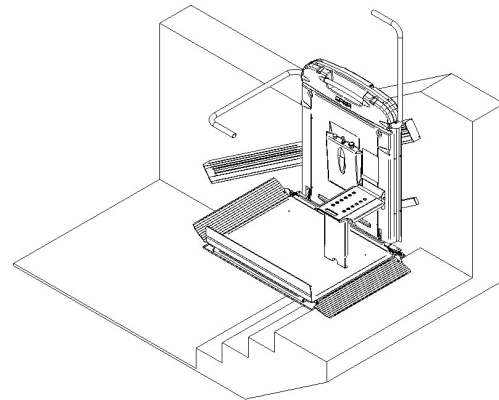

Handi-lift at landing at the top of the stairs

2 Operation of Handi-Lift EA9

2.1 Operation from the lifts control panel

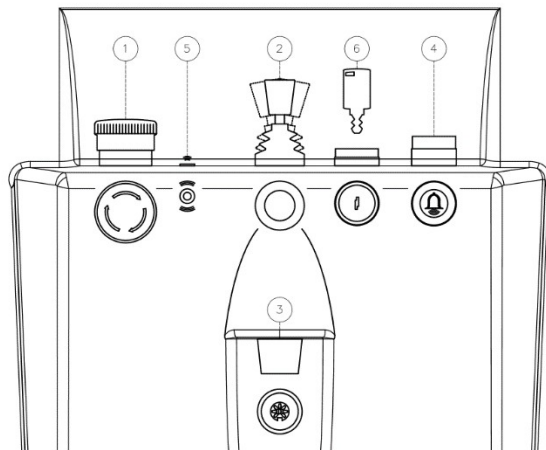

- 1) Emergency stop
- 2) Joystick
- 3) *Connection for remote control with spiral wire
- 4) Emergency call
- 5) Light diode
- 6) *Key lock

* Extra equipment (not standard on all lifts).

The control panel of the Handi-lift is situated as shown on the sketch section 1.2 pos. 13.

2.1.1 Emergency stop

If the red button is pushed down, the emergency stop will be activated, and a light will appear (pos. 1 on the sketch above). The emergency stop will cut off the power supply for the lift, and if the emergency stop is activated it is not possible to drive with the lift. To release the emergency stop you need to turn the red button clockwise until the button comes up again and the lift can now drive again. Please make sure that the emergency stop always is released.

2.1.2 Joystick

You use the joystick, (pos. 2 on above sketch) on the Handi-Lift by pushing the joystick in the direction you wish to drive. The Hand-lift stops automatically when it reaches the end of the stairs or a landing.

Please note! If you let go of the joystick while driving, the lift will stop, and it takes a couple of seconds before the joystick will start the lift again.

2.1.3 Connection for remote control with spiral wire

The connection for the remote control with spiral wire (pos. 3 on sketch in section 2.1) is not standard on all lifts; see further information in section 2.3. If the lift is not bought with remote control with spiral wire from the beginning this connection is not on your lift.

2.1.4 Emergency call

The emergency call button (*pos. 4 on sketch in section 2.1*) is standard on all lifts. Activate the emergency call button by pressing the button and an alarm will start as a signal that you need help.

2.1.5 Light diode

The light diode lights green (*pos. 5 on sketch in section 2.1*) when there is power on the lift and the emergency stop is deactivated. The lift can only be used when the green light is on. If the light diode is flashing, there is overload on the lift.

2.1.6 Key lock

The key lock cuts off the power to the lift, so the lift cannot be used.

2.2 Operation from control box on wall or column

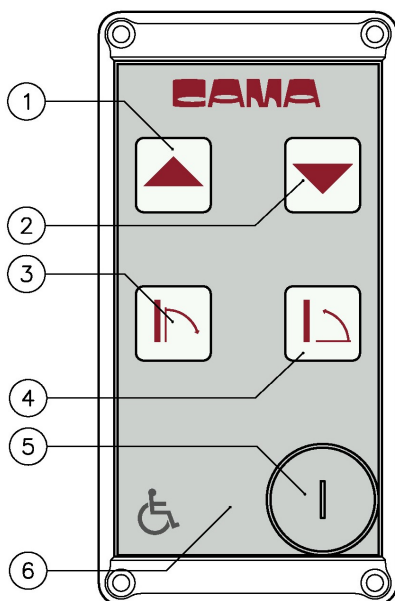

- 1. Up
- 2. Down
- 3. Open
- 4. Close
- 5. Key lock
- 6. Green light diode

The control boxes can vary in look, but the symbols for the functions are the same on all type of boxes.

The Handi-Lift is a fully automatic lift, where the user does not need to operate anything manually; al operation is electrically controlled. The control box as shown above is not necessarily standard, as the lift can be operated by a remote control (*see section 2.4*). The control box can be used to call the lift to the desired position either by the user or a helper. A helper can operate the lift from the control box.

The control box is installed at the top and the bottom of the stairs but can in some cases also be installed in a special column. **Control boxes with power supply** can only be used when the green lamp is lit on both

control boxes. The control boxes can be locked with the key lock and the green light is turned off on both control boxes. On **control boxes with battery supply** the green light will first be lit when one of the buttons is pushed. The key lock will only lock the control box in question. The control box uses 3 AA batteries, and these will be replaced during maintenance or when needed.

2.2.1 Up

The UP-button (*Pos. 1 on sketch in section 2.2*) is used to drive the lift up the stair, the button needs to be pushed down and held down in order to get the lift to drive. If the button is released during the drive, you need to wait a couple of seconds before the button will activate the lift again. If you are standing at the top of the stairs or, and the lift is parked at the bottom of the stairs, you can use the UP-button to call the lift to the desired position.

2.2.2 Down

Down-button (*pos. 2 on sketch in section 2.2*) is used to drive the lift down the stairs. The Down-button works as the UP-button, except that it drives the lift down the stairs.

2.2.3 Open

The Open-button (*pos. 3 on sketch in section 2.2*) is used to fold the platform down, so you can drive on the lift. Please note that you need to drive on the lift with the front downwards. Remember to brake the wheelchair.

The Open-button only works when the lift is parked at upper or lower end position.

Warning! Never open the platform if there is a person or an object under the platform.

2.2.4 Close:

The Close-button (*pos 4 on sketch in section 2.2*) is used when you want to park the lift. Push the Close-button down and the barrier arms goes down and the platform is closed automatically. Please note that the Close-button only works when the lift is positioned at the upper or lower end position

2.2.5 Key lock

Warning! Never close the platform if there is a person or an object on the platform.

Control box with battery supply

The key lock (*pos. 5 on sketch in section 2.2*) is used to lock the control box and only this control box. By turning the key, you will turn on the power supply to the control box. The control box is turned on when the key is horizontal.

Control box with power supply

The key lock (*pos. 5 on sketch in section 2.2*) is used to lock both control boxes and the green light is turned off on both control boxes.

2.2.6 Light diode

The light diode (*pos. 6 on sketch in section 2.2*) is lit when the control box is turned on.

2.3 Remote control with spiral wire:

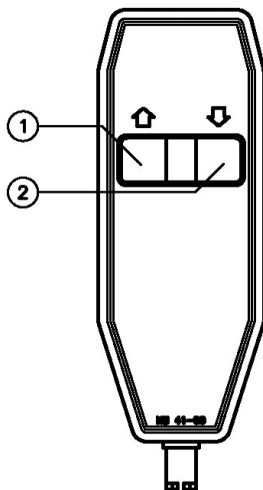

1. Up
2. Down

The remote control with spiral wire is extra equipment and not standard on all lifts. The remote control with spiral wire can replace the function of the joystick and is often used by a helper. The remote control is connected to the control panel on the lift (*pos. 3 on the sketch in section 2.1*); please observe that the guide pins on the plug fits, when you insert the plug.

2.3.1 Up

Push the Up-button down and hold it down (*pos. 1 on sketch above*), this will make the lift drive up.

2.3.2 Down

Push the Down-button and hold it down (*pos. 2 on sketch above*), this will make the lift drive down.

2.4 Operation with wireless remote control:

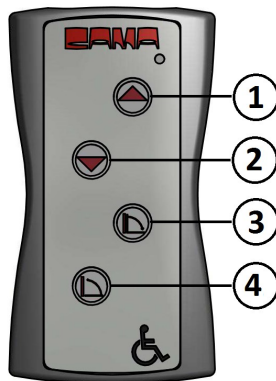

1. Up
2. Down
3. Open
4. Close

The wireless remote control, as shown on the sketch, is extra equipment and is not standard on all lifts. The remote control can replace the control box (see section 2.2.). The remote control can be used to call the lift to the desired position either by the user or a helper. A helper can operate the lift with this control. **OBS: when using the wireless remote control, the lift MUST be under supervision.**

2.4.1 Up

The up-button (pos. 1 on the above sketch) is used to drive the lift up the stairs, push the button down and hold it down to get the lift to drive. If you let go of the button when driving, you will have to wait a couple of seconds before the button can activate the lift again.

If you are positioned at the top of the stairs and the lift is parked at the bottom of the stairs, you can use the up-button to call the lift to the desired position.

2.4.2 Down

The down-button (pos. 2 on above sketch) is used to drive the lift down the stairs. The down-button works as the up-button, except it makes the lift go down the stairs.

2.4.3 Open

The open-button (*pos. 3 on above sketch*) is used to fold the platform down, so you can drive on the lift. Please note that you must drive on to the lift with the front downwards. Remember to brake the wheelchair. The open-button works only when the lift is parked on upper or lower landing.

Warning! Never fold the platform down if there is a person or an object under the platform.

2.4.4 Close

The close-button (*pos. 4 on the sketch in section 2.4*) is used when you wish to park the lift. Push the close-button and the barrier arms go down and the platform is closed automatically. Please note that the close-button only works when the lift is parked on upper or lower landing.

Warning! Never fold the platform up if there is a person or an object on the platform.

3 Emergency lowering

Disconnect the power to the lift on the main switch!
Find the 8mm Umbraco screwdriver that came with the lift.

3.1 Emergency raise of the barrier arms

EMERGENCY RAISING

Remove the rubber plug on the lifts front cover. (*pos. 16 and 17 on the sketch in section 1.2*); put the screwdriver in the hole for the barrier arm you which to raise. Turn the screwdriver counter-clockwise to release the barrier arm. The barrier arm can now be opened.

Warning! You must never raise the lower barrier arm if the lift is not parked at the bottom of the stairs. **Contact your dealer if you have emergency raised the barrier arm.**

3.2 Emergency raise of the platform

 EMERGENCY RAISING

Remove the rubber plug in the left side of the lifts front cover (*pos. 15 on sketch in section 1.2*); Put the screwdriver in the hole and turn it clockwise to raise the platform (close the platform).

Warning!	Never try to raise the platform if a person or an object is on the platform
-----------------	---

3.3 Emergency lowering of the lift

To emergency lower the lift you need to drive the lift down; the handle is turned anti-clockwise.

Warning!	<p>Never try to emergency lower the lift if the lifts drop lock is activated. Contact the dealer immediately.</p> <p>We do not recommend that the emergency lowering of the lift is carried out by others than the technicians of your dealer's company.</p>
-----------------	--

4 Extra equipment

4.1 Side access ramp

The side-access-ramp (*pos. 6 on sketch in section 1.2*) is only used when there is a specific wish or when there is not enough room to drive off the lift at the bottom of the stairs.

Please note that you must drive on the lift with the front downwards. Remember to brake the wheelchair.

4.2 Fold down seat

Walking impaired persons can use a fold down seat (*pos. 7 on sketch in section 1.2*). The fold down seat is operated manually and is folded down by tipping the seat; before you sit down, please make sure the support leg is completely folded out and firmly placed on the platform. Please note that if you do not fold the fold down seat up after use a spring will automatically fold the seat up when the platform is folded up.

4.3 Alarm/emergency call

Alarm (*pos. 18 on sketch in section 1.2*) is only used if there is a specific wish or demand that an alarm shall make a sound when the lift is driving. If the lift is placed in a public place alarm/emergency call is not extra equipment but is compulsory.

4.4 Flashlight

Flashlight (*pos. 19 on sketch in section 1.2*) is only used if it is a specific wish or demand that a light shall flash when the lift is driving.

On lifts where it is not possible to see the entire driving range of the lift from the control boxes, or where the client requires it, the lift can be equipped with flashlight and sound in order to warn about danger on the stair.

4.5 Rain cover

On outdoor lifts you can get a rain cover, which will protect the lift against sun, wind and weather as well as vandalism.

5 What to do if your lift fails to operate

If the schedule below does not solve the problem, please contact your maintenance company.

Symptom	Cause	Solution
The lift will not start (no light in the control lamps)	Disconnected on the safety switch	Turn on the safety switch
	Emergency stop on lift is activated	Release emergency-stop by turning it to the right in the arrows direction
	Fuses in the main switchboard or RCCB-relay	Change fuses or activate RCCB-relay

The control lamp is flashing, and the lift will emit an acoustic signal	Overload (see section 1.3 concerning load cell)	Drive back to the start point and minimize the load.
Lift will not drive up	Safety limit switch at the ramp closest to the stair is activated	The ramp is pushed towards the stair (limit switch is deactivated)
Lift will not drive down	Safety limit switch at the ramp away from the stair is activated	The ramp is pushed away from the stair (limit switch is deactivated)
Barrier arms will not drive up automatically at the bottom position	There is an object below the lift	Drive the lift a bit up and remove the obstacle under the lift platform. Please call the service provider if the obstacle is difficult to remove
Lift stops between the landings	Fuses in main power board or RCCB-relay	Change fuses or activate RCCB-relay
	Upper or lower ramp limit switch on platform is activated	Release ramp limit switch or remove obstacle. Call the service provider if this is not possible

6 Warnings

NEVER allow more than one person on the lift. (See maximum load on nameplate on the lift).

ALWAYS observe the lift's lane.

NEVER allow children to play with the lift.

NEVER allow water to come in contact with the electrical parts in the lift.

NEVER place objects on the rail or on the stair, where they can come in contact with the lift when in use.

ALWAYS remember to brake the wheelchair, so it does not move when driving.

ALWAYS drive on the lift facing downwards.

NEVER attempt to help the barrier arms raise or lower.

NEVER attempt to emergency lower the lift up or down if the overspeed governor is activated. Contact the maintenance company immediately.

Please note! Snow can cause a breakdown. Remove all snow from the lift's lane and the landings **BEFORE** using the lift.

7 Service

The Handi-Lift is delivered mounted and tested by trained and by Cama authorised personnel. The number of inspections of the lift per year depends on the law in your country, however Cama recommends that the Handi-Lift is examined minimum once a year. Possible errors between the inspections must be reported to the supplier or a by them approved person immediately.

For safety reasons it is recommended that you only use original spare parts and that the reparation is carried out by authorised personnel. Should non-original spare parts be used, and the repair carried out by unauthorised personnel the warranty is no longer valid

8 Cleaning

Before starting the cleaning of your lift, the power on the lift **MUST** be turned off (*see section 2.2*). Remember to turn the lift back on after the cleaning.

The Handi-Lift is made of material, which is easy to wipe off. The painted metal and the plastic parts must be wiped off with a damp not wet cloth. You may under no circumstances use abrasive cleaners, bleach or solvent-based cleaners, as these will damage the surface. Please remember that excess water can cause problems if it enters the lift's electrical parts.